

All dimensions are to be checked on site. Do note scale from this drawing

Proposals are subject to site survey and statutory approvals

Note : This drawing has been prepared based on a PDF document. The red line boundary has been taken from the PDF document and will need to be confirmed to allow GIA areas and site layout to be confirmed.

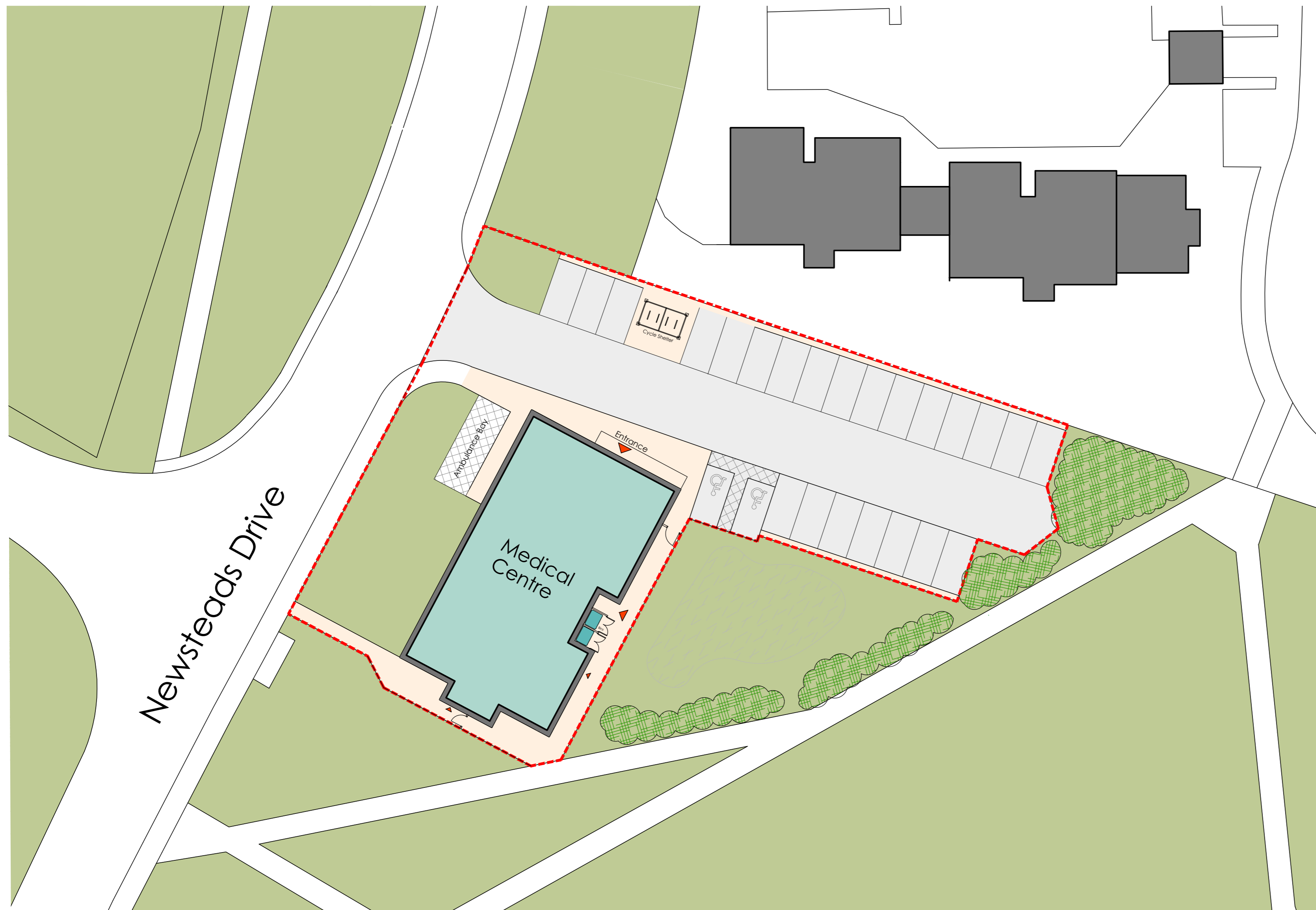

P1	First issue	31.03.21
Rev	Description	Date



Keel Row 4 | The Watermark | Gateshead | NE11 9SZ  
 E: info@iba-architects.com T: 0191 461 1411  
 www.iba-architects.com

Project: Proposed Medical centre  
 Newsteads Drive  
 Monkseaton

Title: Proposed Site Layout

Client: Argon Health

Drawn: AM	Scale: 1:250 @A2
Checked: PW	Date: 31.03.21

**PRELIMINARY**

**1493 (S)02 P1**

THIS DRAWING IS COPYRIGHT

