

Notes:
 Approval/Particulars on the information shown should be obtained prior to being used as a basis for any contract.
 Drawing based on Ordnance Survey data and is subject to a full line & level survey.
 This drawing has been prepared subject to the following:
 1. Planning Approval
 2. Building Regulation Approval
 3. Fire Officers Approval
 4. Highways Approval
 5. Enquiries on location of Statutory Utilities services & equipment.
 Contractors to check dimensions and notify any discrepancies or errors to the company immediately.
 Work to figured dimensions only. Do not scale.
 © All Rights Reserved.

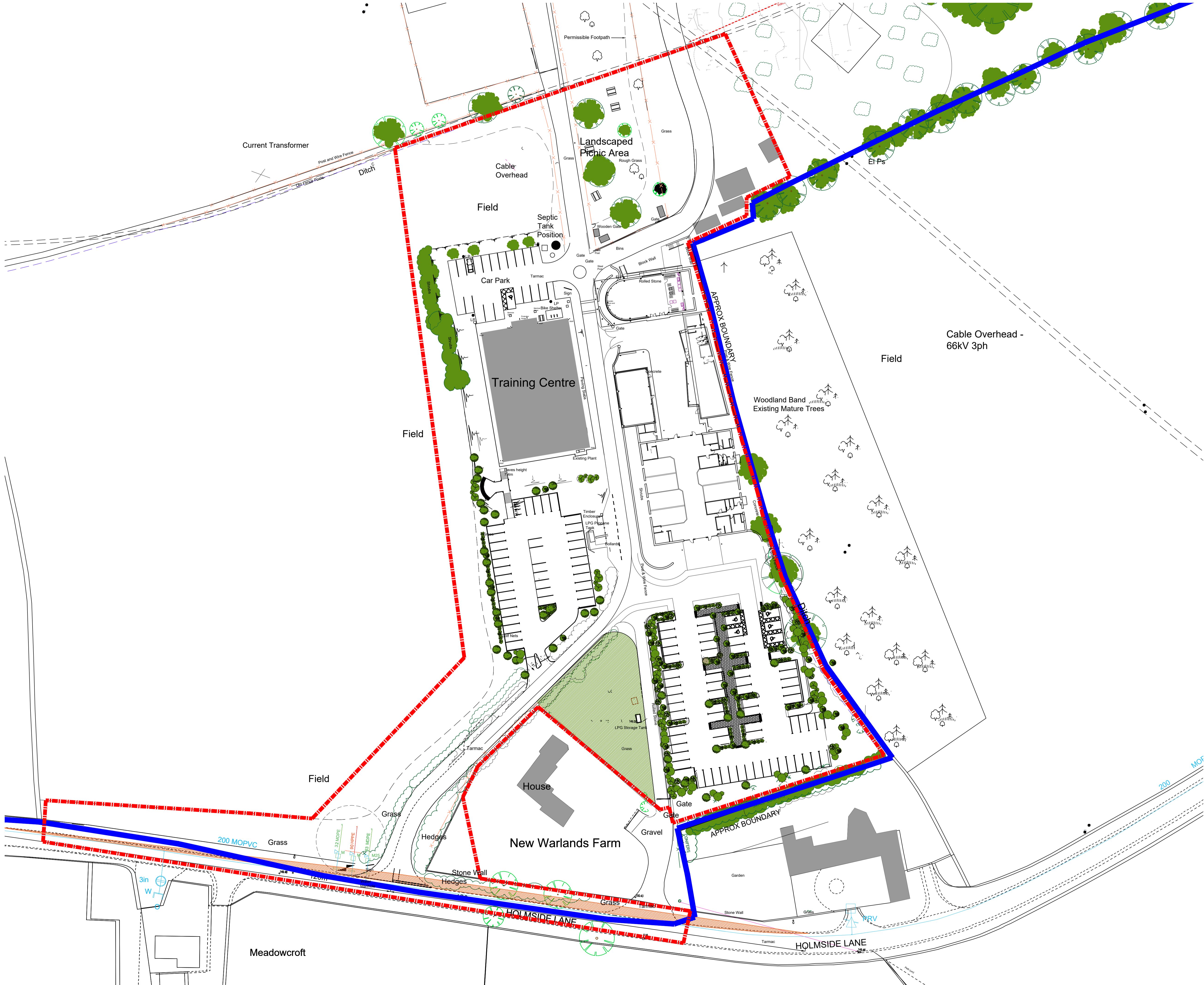
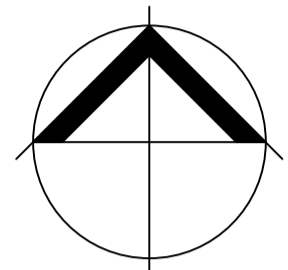

PROPOSED SITE PLAN 1:500

Rev	Date	Description	Drawn	Checked

PWA
 Architectural Consultants
 Studio 2, Chevin Mill
 Leeds Road
 Otley LS21 1BT
 Tel: 01943 468 438
 info@pwaconsultants.com
 www.pwaconsultants.com

Client: **north east autism society**

Project: **New Warlands Farm
 Holmeside, Edmondsley,
 County Durham, DH7 6EX**

Title: **Proposed Site Plan**

Drwg No. 20377 - PA - 03	Rev. -
------------------------------------	-----------

Scale	1:500@A1	Date	DEC'21	Status	Planning
Drawn	MS	Checked	LP		