

THIS DRAWING IS COPYRIGHT AND REMAINS THE PROPERTY OF HTA ARCHITECTS. IT MUST NOT BE REPRODUCED, USED, DISCLOSED OR TRANSMITTED TO THIRD PARTIES IN ANY FORM, IN WHOLE OR IN PART, WITHOUT PRIOR WRITTEN PERMISSION.

DO NOT SCALE!
ALL DIMENSIONS SHOULD BE CHECKED ON SITE BEFORE WORK COMMENCES.

BASED ON MT SURVEY'S TOPOGRAPHIC SURVEY REF: "1086-118" RECEIVED 25.10.18

BASED TITLE PLAN REF: "WYK289133"

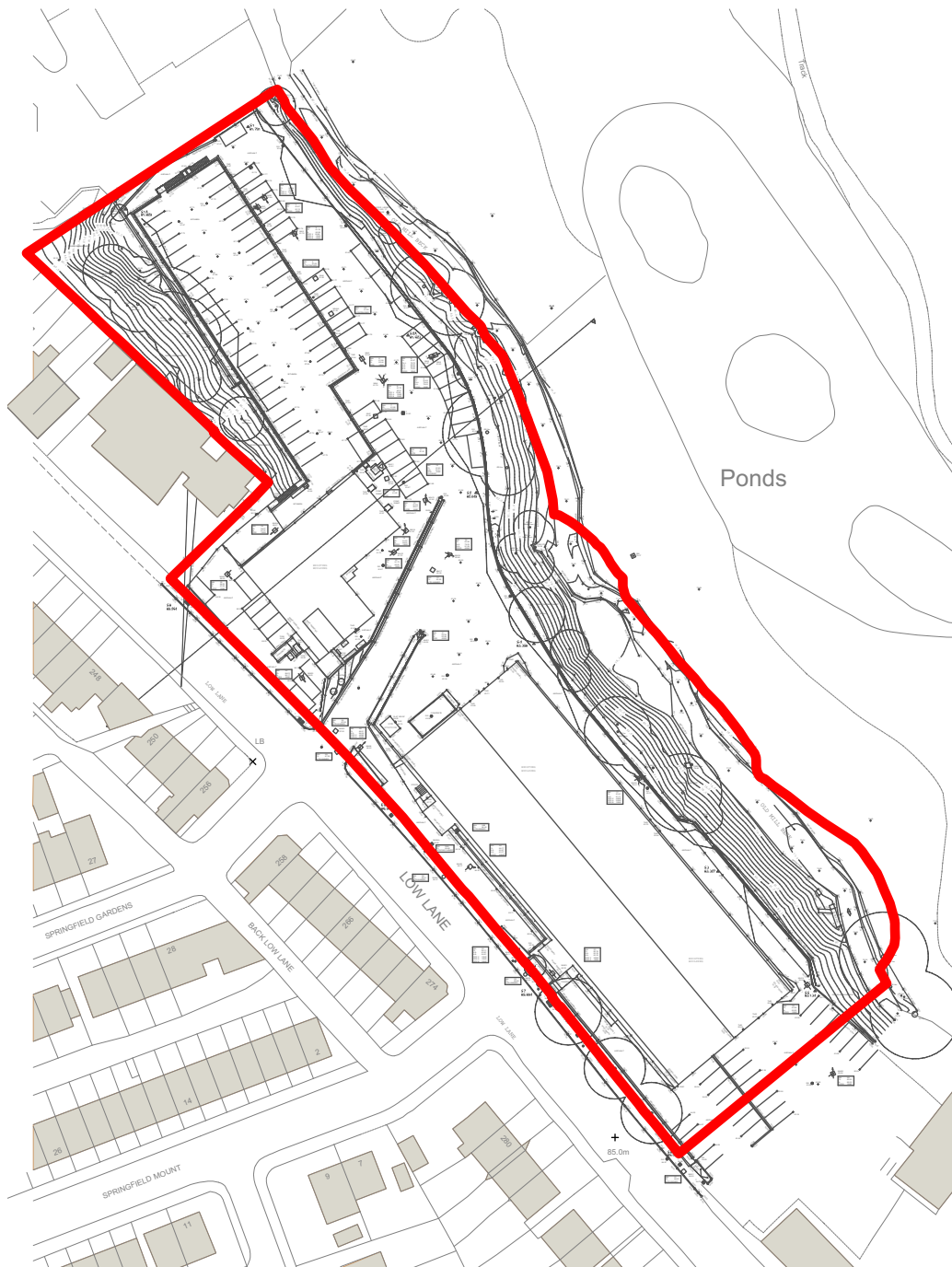

Rev	Date	Description	Drawn
A	27.04.20	Title Plan note updated	LS

htaarchitects

York Place Studio
8 Britannia Street
Leeds
LS1 2DZ
T: (0113) 244 3457

W: www.htaarchitects.co.uk
E: info@htaarchitects.co.uk

client
Lidl GB Ltd



project
Woodside Trading Estate,
Horsforth

drawing title
Site Location Plan

date December 2019
status Planning
scale 1:1250 @ A4
drawn JBH checked LS
job no. 2184 dwg no. P402 rev. A